



<http://www.lcdtvenclosure.com>

Anti Ligature Clock Enclosures FAQ's.

What is an anti-ligature clock enclosure?

An anti-ligature clock enclosure is a protective case that is designed to prevent the use of the clock as a ligature point for self-harm or suicide.

What are some materials used to make anti-ligature clock enclosures?

Anti-ligature clock enclosures can be made from a variety of materials including steel, stainless steel and aluminum.

What types of clocks can be used with anti-ligature clock enclosures?

Anti-ligature clock enclosures can be used with a variety of clocks, including wall clocks and digital clocks. Proenc's solution comes with a digital clock as standard.



What is the purpose of an anti-ligature clock enclosure?

The purpose of an anti-ligature clock enclosure is to prevent individuals from using the clock as a means of self-harm or suicide in institutional settings such as correctional facilities, psychiatric hospitals, and schools.

<http://www.lcdtvenclosure.com>

Can anyone claim their product is a ligature resistant clock?

Yes, unfortunately some companies see a unique design like our patent pending clock enclosure and decide to create an inferior product as below.

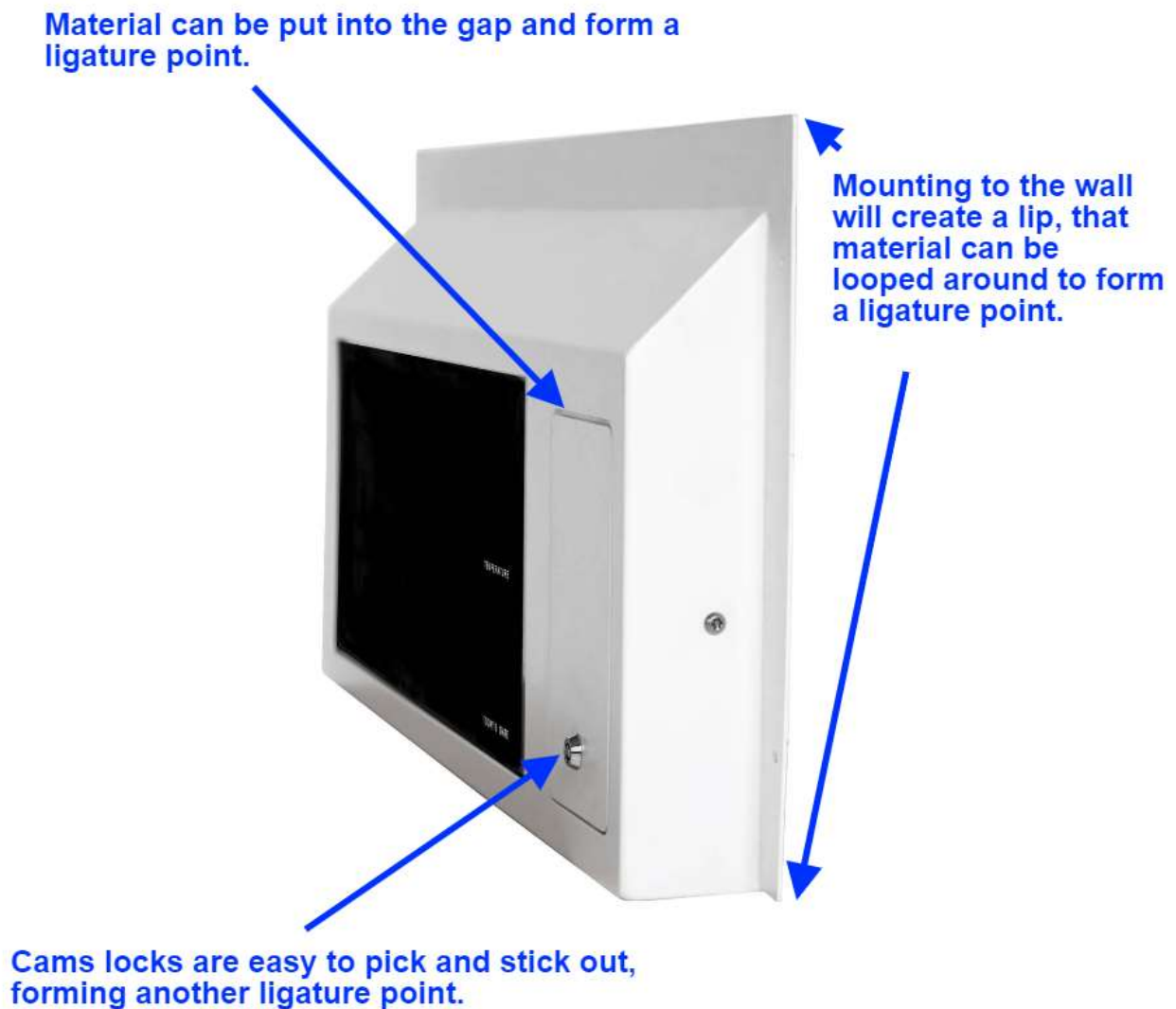

Are anti-ligature clock enclosures tamper-proof?

Anti-ligature clock enclosures are designed to be tamper-resistant, but not necessarily tamper-proof. With enough force or the right tools, it is possible to break into the enclosure.

US Office: 8 The Green, Suite #6777
Dover, DE 19901
T: (862) 234-5981



<http://www.lcdtvenclosure.com>

How are anti-ligature clock enclosures installed?

Anti-ligature clock enclosures can be installed directly onto a wall or mounting bracket using screws or bolts.

Can anti-ligature clock enclosures be customized?

Yes, anti-ligature clock enclosures can be customized to fit the specific needs of an institution or facility. Customization options can include size, material, color, and locking mechanisms.

Are anti-ligature clock enclosures expensive?

The cost of an anti-ligature clock enclosure can vary depending on the size, material, and level of customization. However, they tend to be more expensive than standard clock enclosures due to their specialized design.

Do anti-ligature clock enclosures require maintenance?

Anti-ligature clock enclosures require minimal maintenance. They should be cleaned regularly with a non-abrasive cleaner to maintain their appearance and functionality.

For more information contact ProEnc on (862) 234 5981.

All information is supplied under ProEnc's terms and conditions and cannot be provided to any third party without written permission from ProEnc and the information supplied may change without notice which is available at <http://proencltd.com/downloads/Terms&Conditions.pdf>